

# Streetscaping of Roads in Delhi

---

Narwana Road – Mother Dairy to Panch Mahal Awas

PWD, Govt. of NCT of Delhi

# Narwana Road – 2.1 Km Approx.

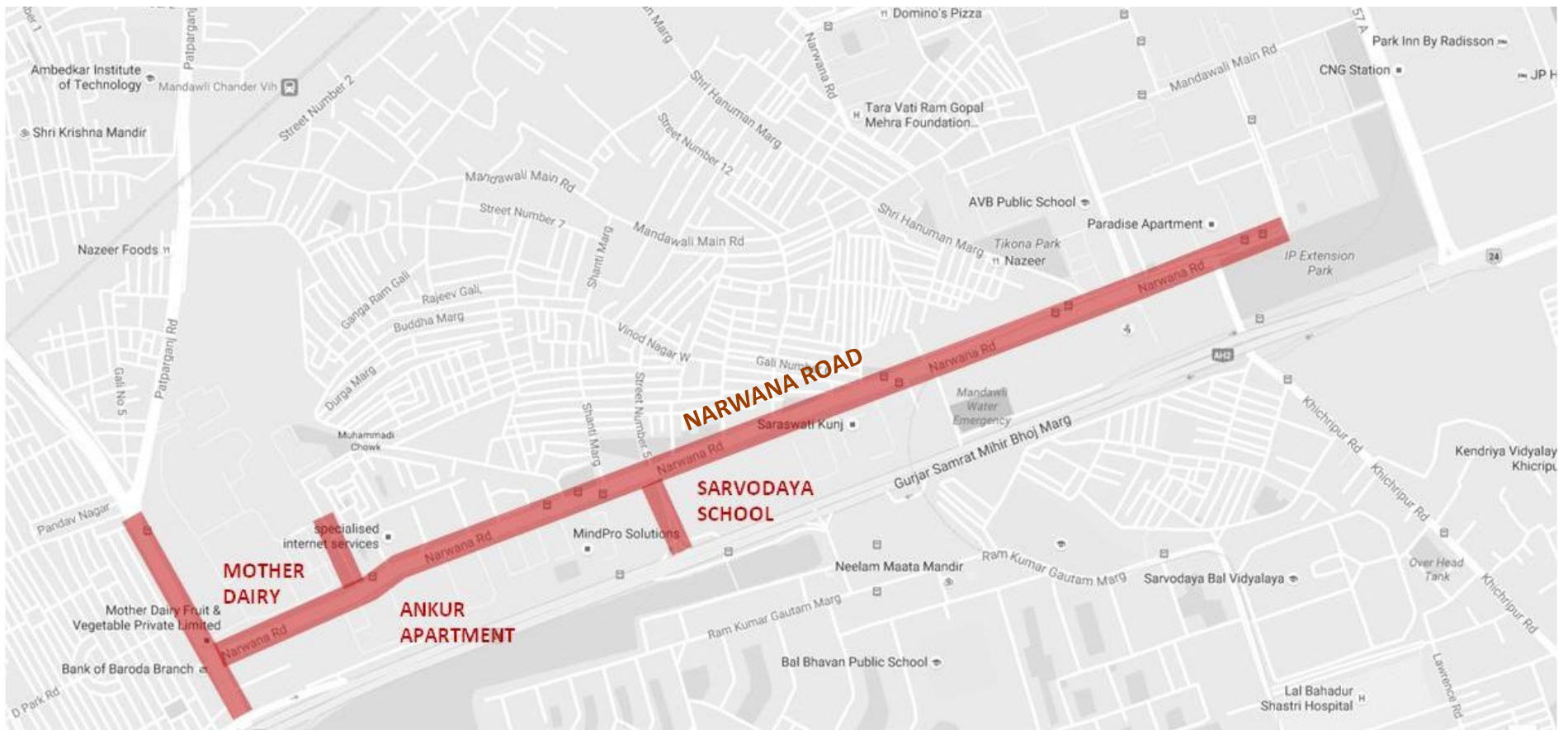

# Streetscaping: Objectives & Principles

---

- Equitable Allocation & Efficient Use of Space
- Improved Road Geometry
- Safety
- Decongestion of Intersections
- Improved Urban Aesthetics



# Streetscaping: Objectives & Principles

---

- Encourage the use of Non-motorised Vehicles, Public Transport & Walking
- Accessible to persons with Disabilities
- More Amenities, User-friendly & Fun
- A Better Quality of Life & A Sense of Well-being





# SAFE INTERSECTIONS

---

Making Intersections Safe for All Users

# Junctions in Delhi: Key Issues

- **Lack of Safe Pedestrian Crossings, Footpaths & Refuges**
- **Missing Road Markings, Signage and Signals**
- **Poor Road Geometry**
- **Lack of facilities for Non-motorised Vehicles & Pedestrians**
- **Termination of Service Lanes at Junctions**
- **Parking close to intersections hinder movement**
- **Poor condition of street, kerbs and street furniture**
- **Barrier-Free Movement not Possible**



# Separation of MV & NMV Traffic

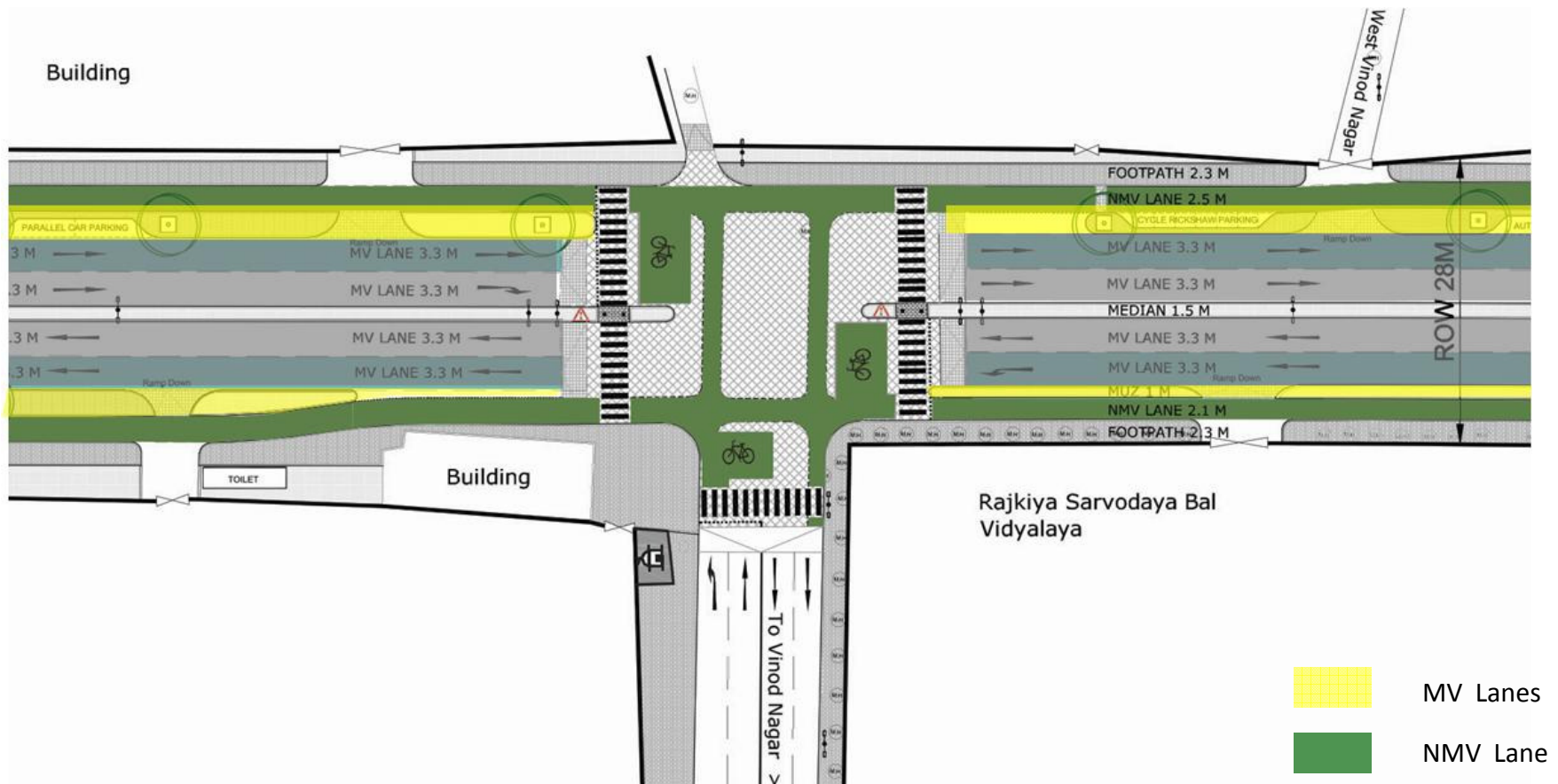

# Alignment of NMV Lanes at Junctions

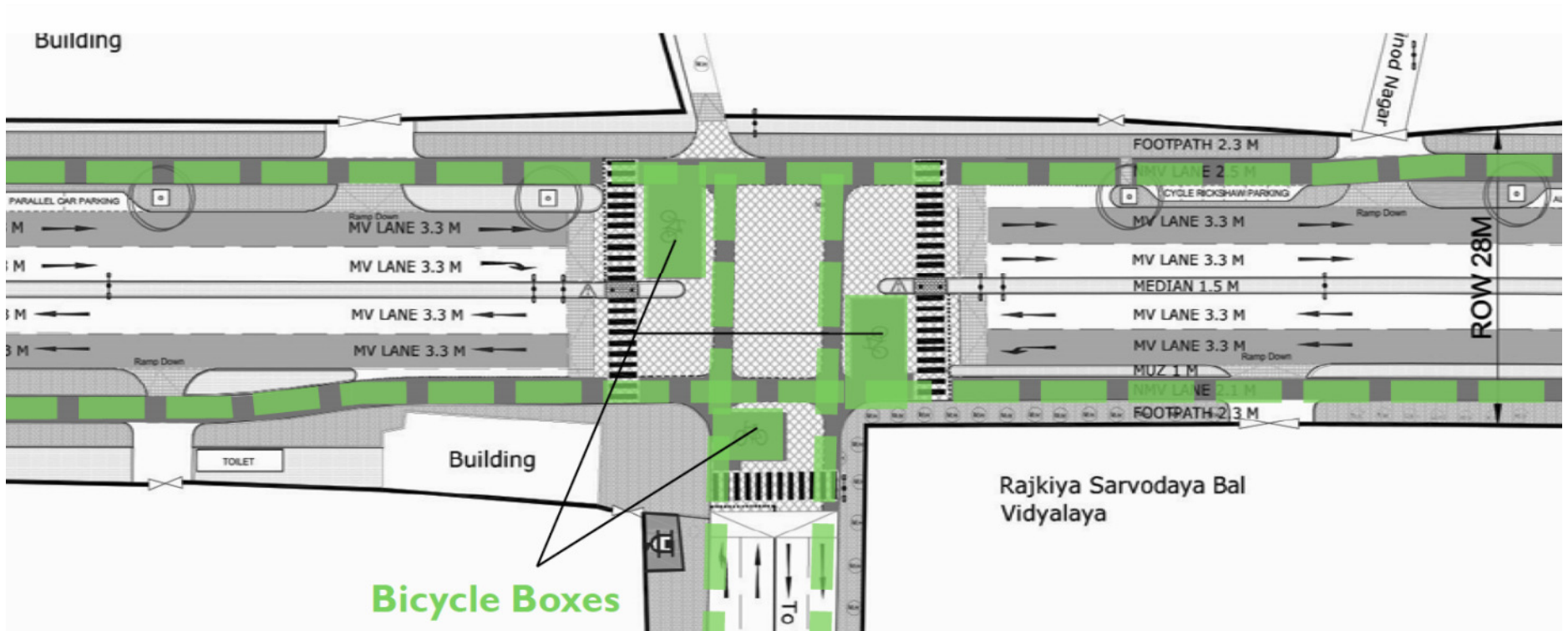

# Wide Footpaths & Pedestrian Crossings

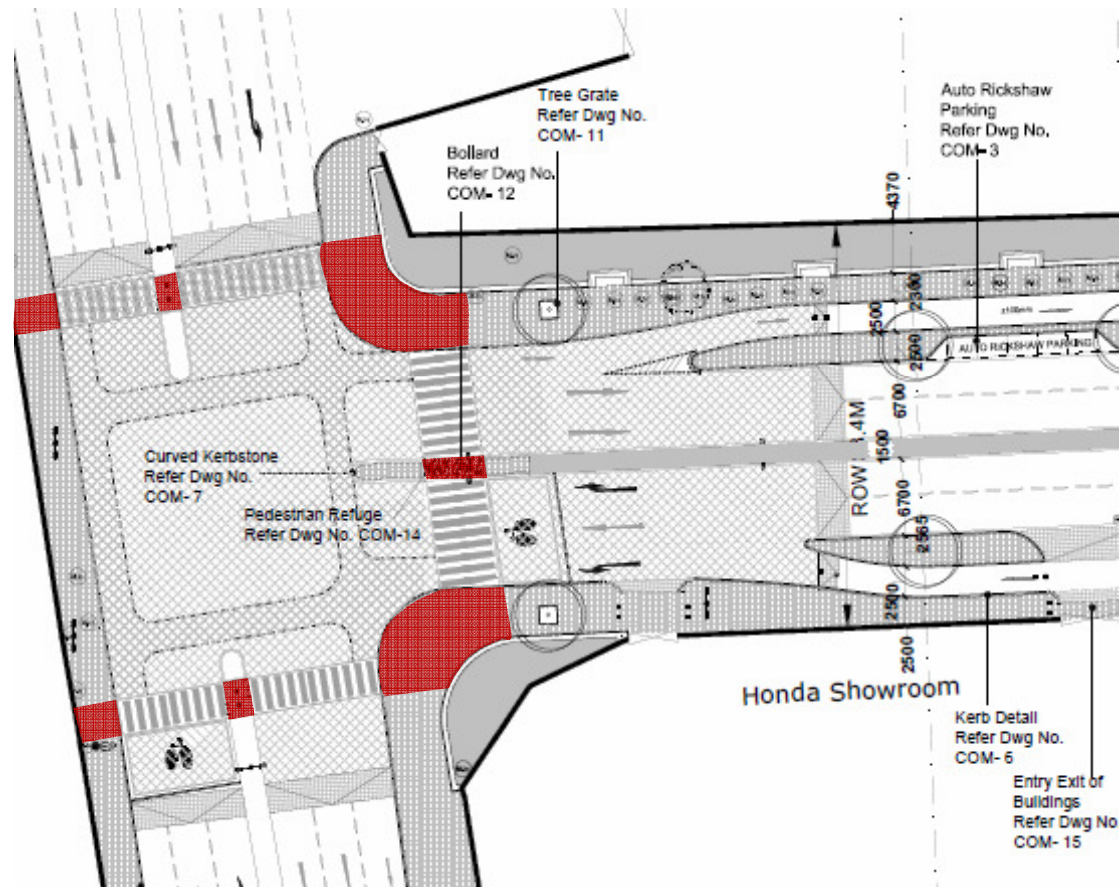



# Raised Intersection with Material Change for Traffic Calming

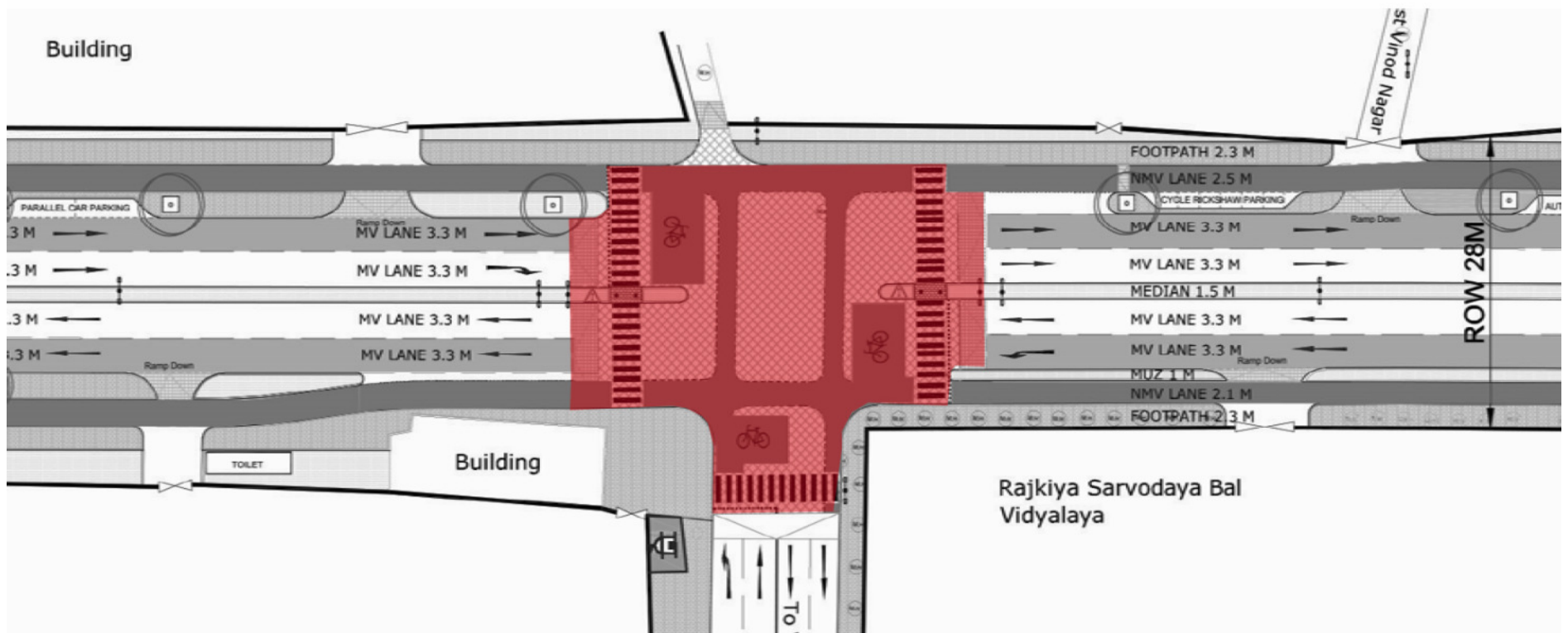

# Raised Pedestrian Crossings/ Traffic Calming

---





# Street Layout : Mother Dairy (Existing)

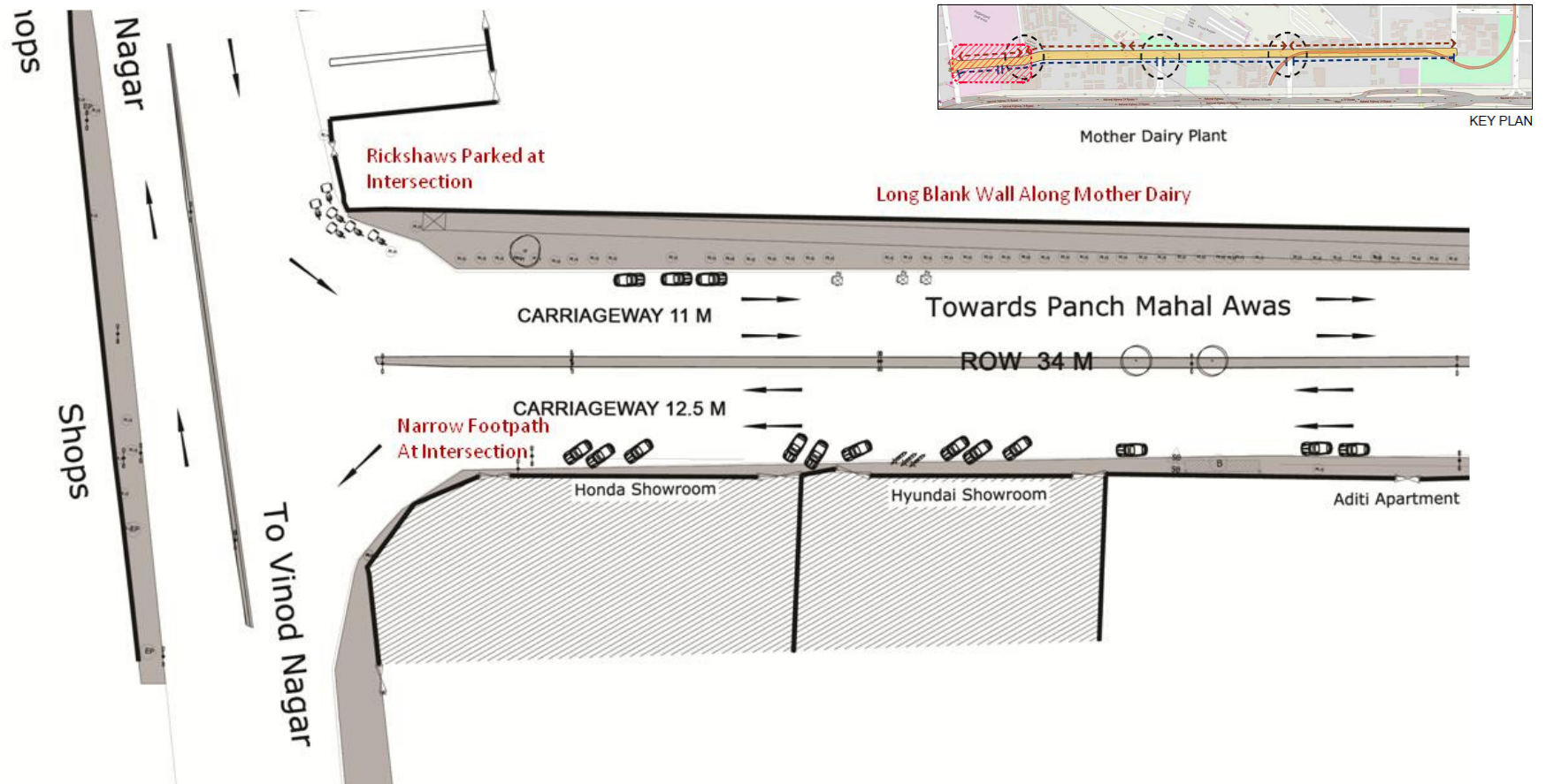

## View: Mother Diary (Existing)

---



# Street Section: Mother Diary (Proposed)

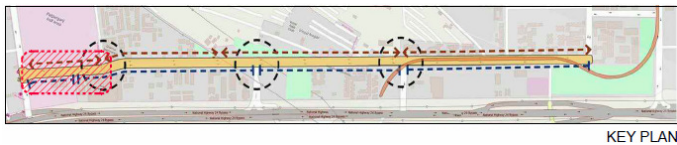
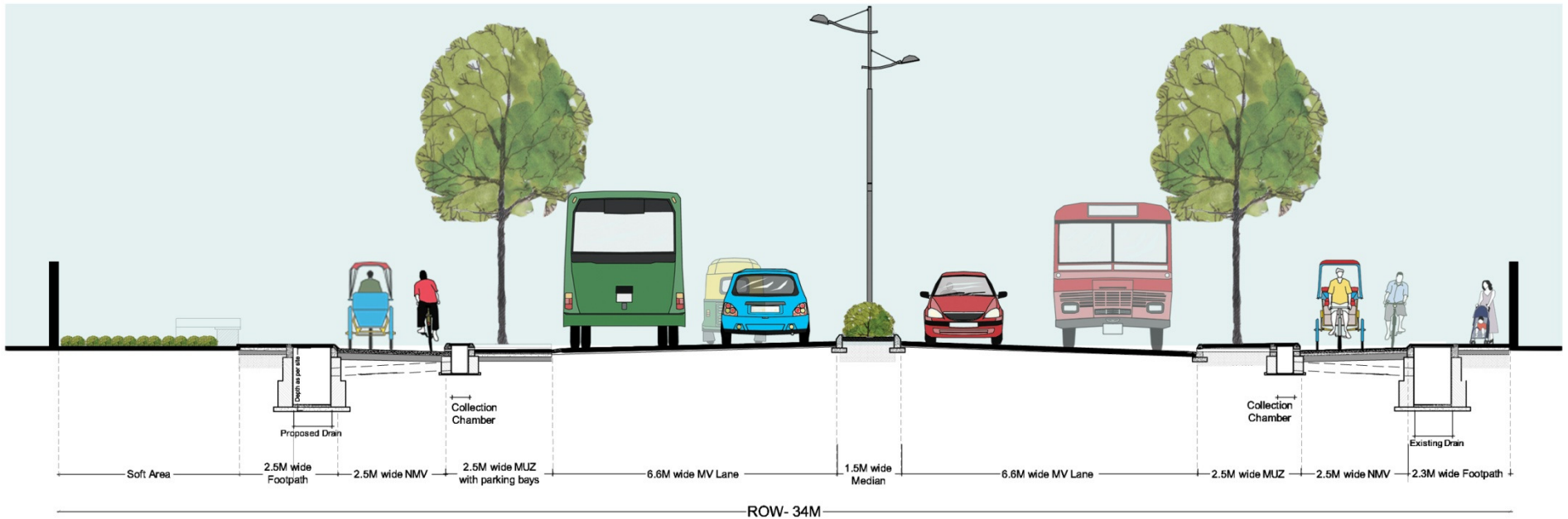



1 2 3 4

Tree Grate Refer Dwg No. COM- 11

Bollard Refer Dwg No. COM- 12

Auto Rickshaw Parking Refer Dwg No. COM- 3

Cycle Rickshaw Parking Refer Dwg No. COM- 4

Bus Stop Refer Dwg No. COM- 10

Kerb Detail Refer Dwg No. COM- 6

Two wheeler Parking Refer Dwg No. COM- 2

Parallel Car Parking Refer Dwg No. COM- 1

Curved Kerbstone Refer Dwg No. COM- 7

Pedestrian Refuge Refer Dwg No. COM- 14

ROW 1.4M

FOOTPATH 2.3 M

NMV LANE 2.5 M

MV LANE 3.1 M

MV LANE 3.1 M

MV LANE 3.1 M

MV LANE 3.1 M

NMV LANE 2.5 M

FOOTPATH 2.3 M

Median 1.5 M

Parallel Car Parking

Parallel Car Parking

Aditi Apartment

Honda Showroom

Hyundai Showroom

Two Wheeler Parking Refer Dwg No. COM- 2

Entry Exit of Buildings Refer Dwg No. COM- 15

Entry Exit of Buildings Refer Dwg No. COM- 15

Entry Exit of Buildings Refer Dwg No. COM- 15

Entry Exit of Buildings Refer Dwg No. COM- 15

Bus Stop Refer Dwg No. COM- 10

Kerb Cut (NMVLANE) Refer Dwg No. COM- 8

Parallel Car Parking Refer Dwg No. COM- 1

Entry Exit of Buildings Refer Dwg No. COM- 15

E B R C

# View: Mother Dairy (Proposed)

---



# Sarvodaya School Junction – Plan: Existing

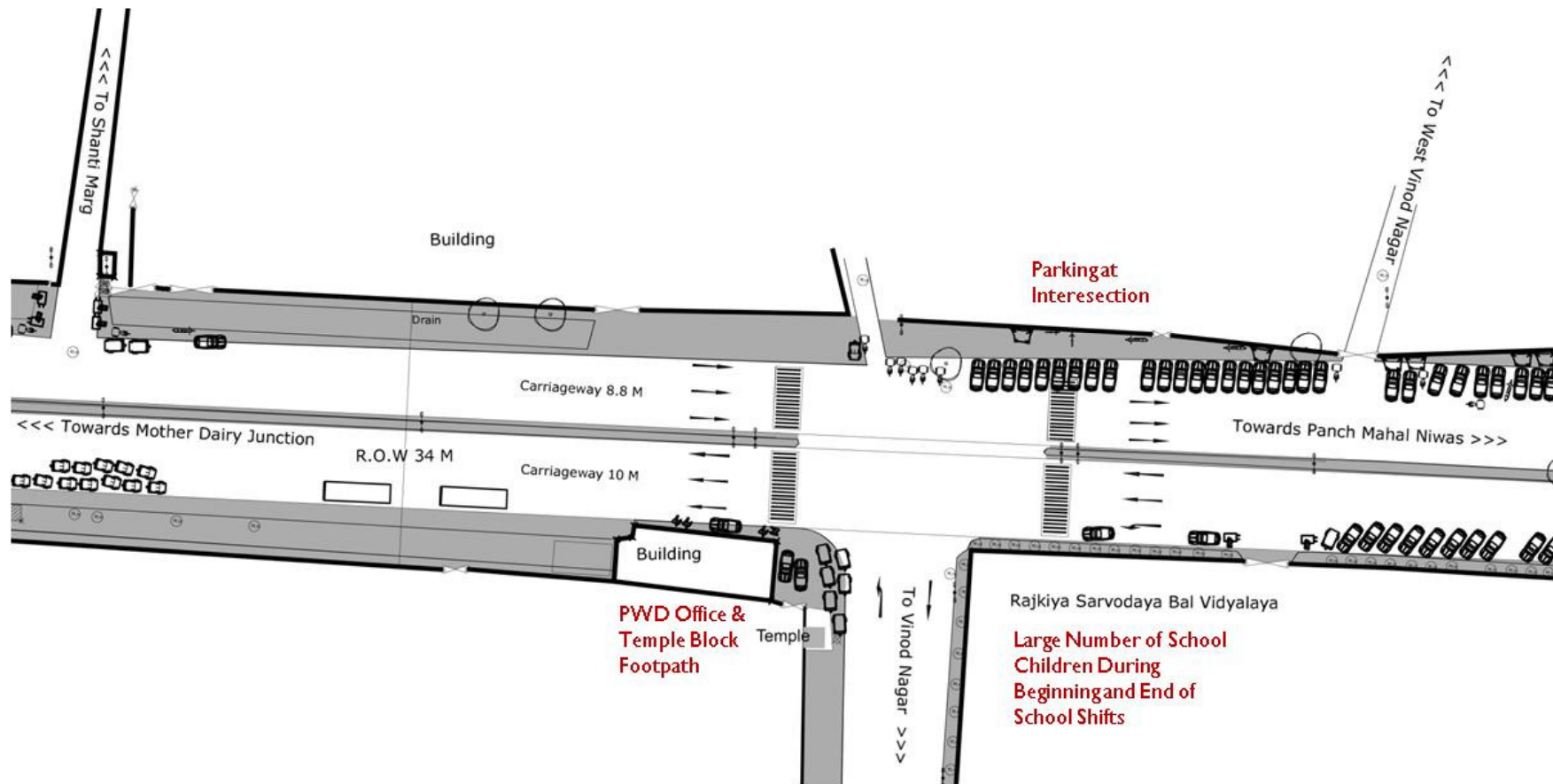



# Sarvodaya School Junction : Existing

---



# Sarvodaya School Junction – Plan: Proposed

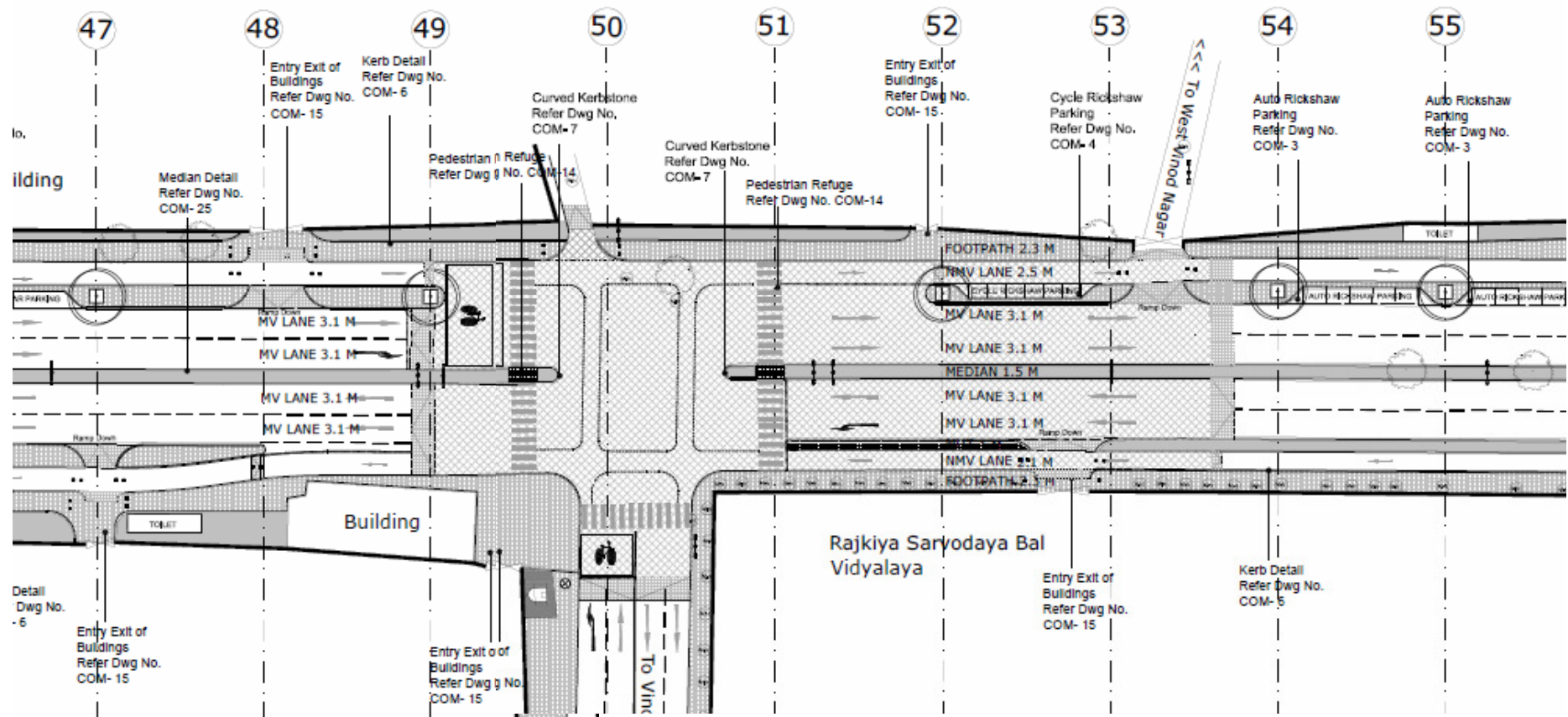



# Sarvodaya School Junction : Proposed



# Street Layout : Typical (Existing)

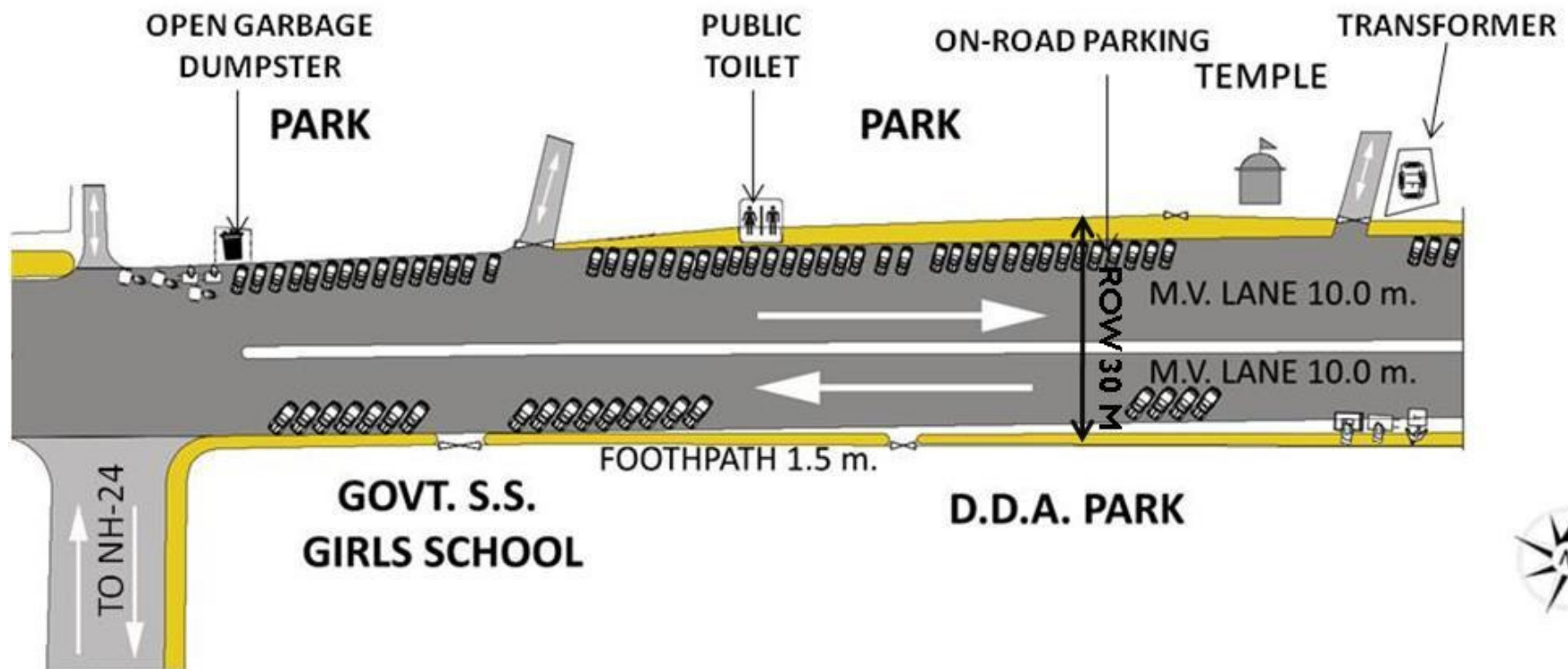



# Typical Usage: Existing

---



# Street Section: Typical (Proposed)

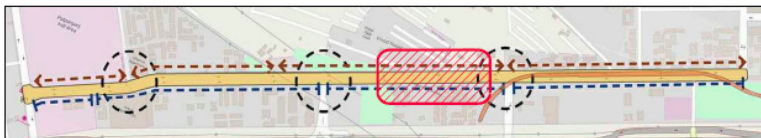
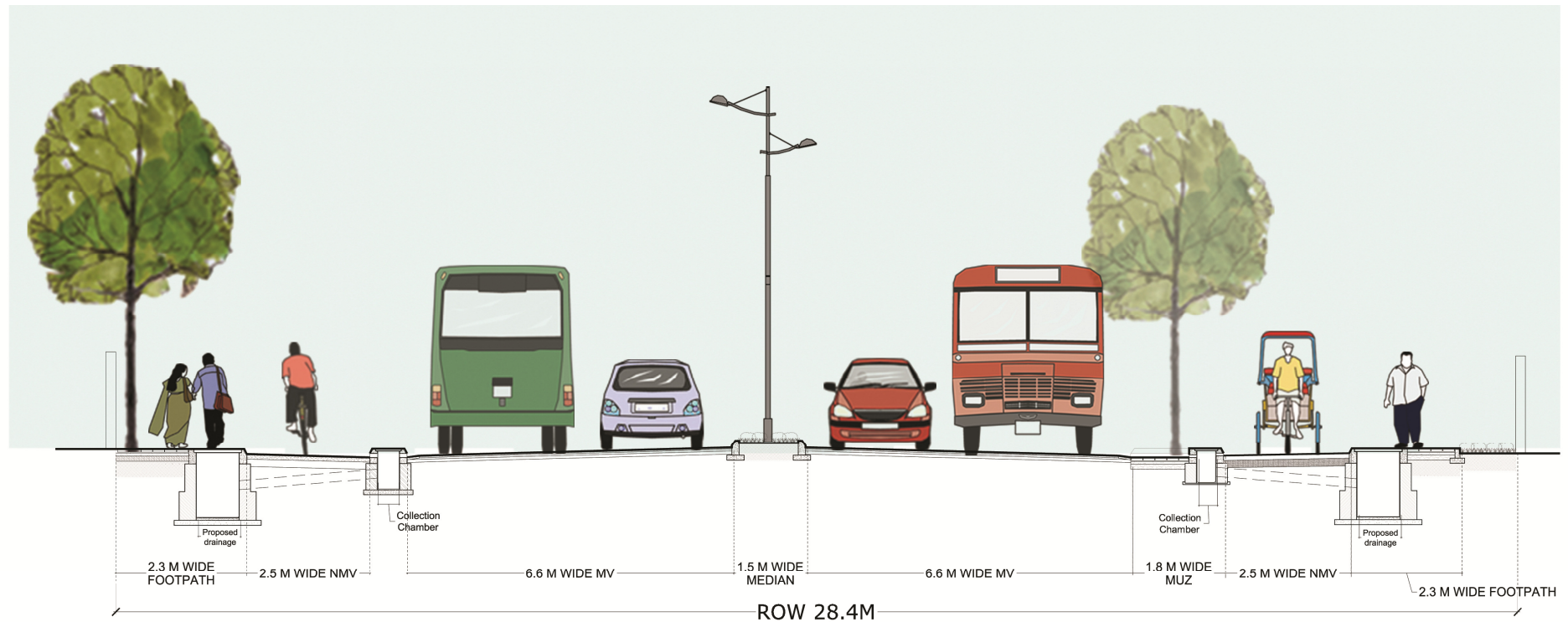



# Street Layout : Typical (Proposed)

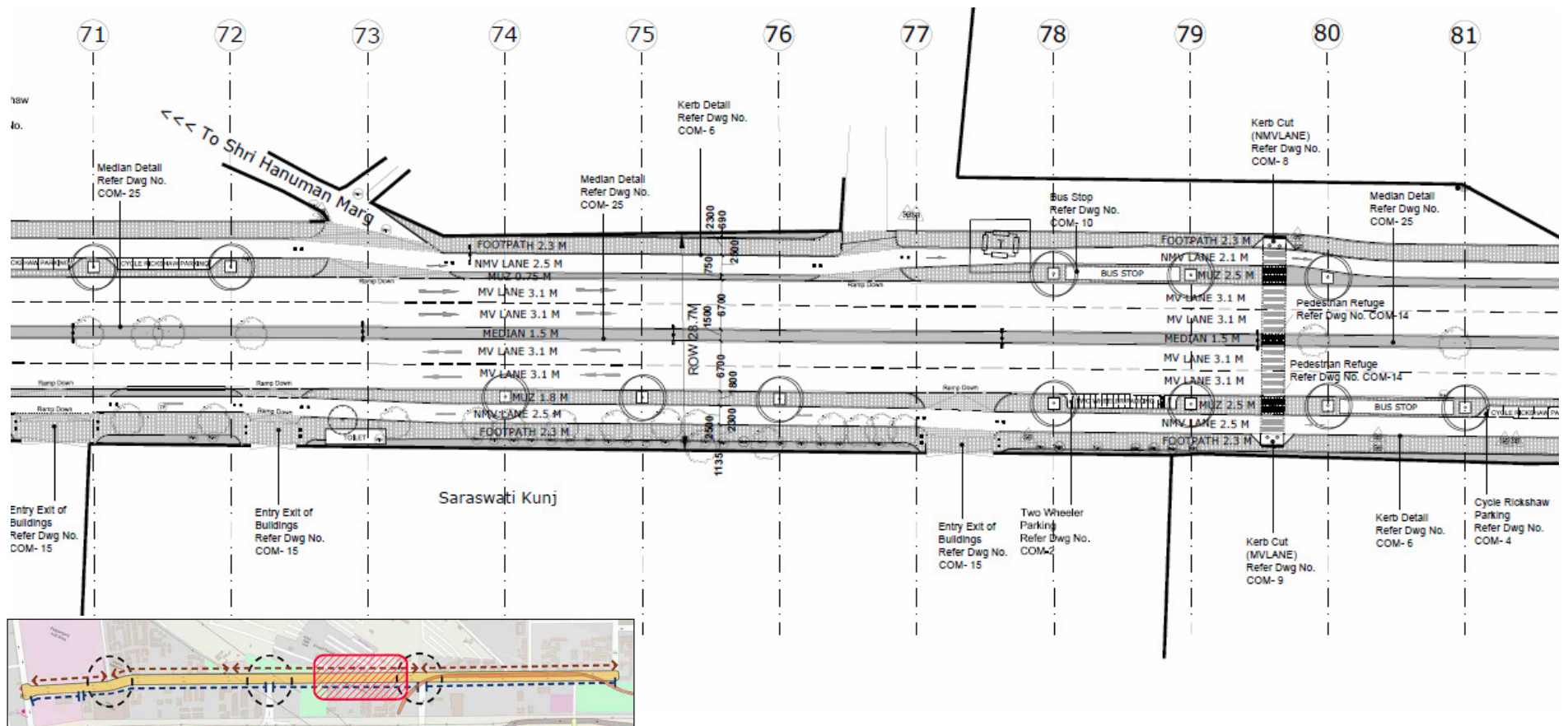



# View: At Metro Station (Proposed)

---



# Street Components

---

# List of Key Street Components/Elements

---

1. Bus stops
2. MV Parking (4wheeler)
3. MV Parking (2wheeler)
4. Bicycle Parking
5. Auto-rickshaw stand
6. Cycle-rickshaw stand
7. E-Rickshaw Stand
8. Gramin Sewa/Phat Phat Sewa Stands
9. Parking for Police & Emergency Vehicles
10. Public Toilets
11. Drinking Water Points
12. KiosksStreet Vending Zones
13. Street Vending Zones
14. Parklets
15. Security/Police Booths
16. Mohalla Clinics
17. Aam Admi Canteens
18. Community Library & Notice Board
19. Trees with Tree Gratings & Tree Guards
20. Planters
21. Benches & Seating
22. Bollards
23. Paving Patterns
24. Kerb cuts & Tactile Paving
25. Maps & Signage



# Public Toilets

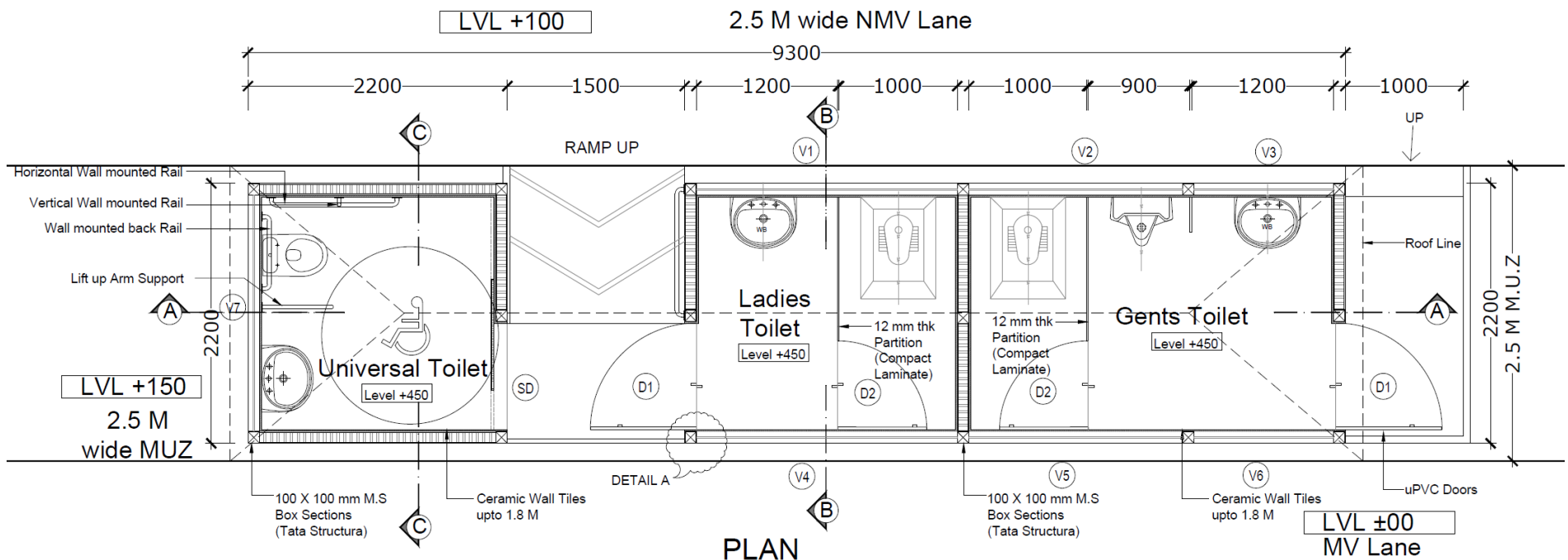

# Police Booth

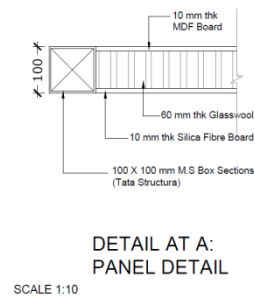
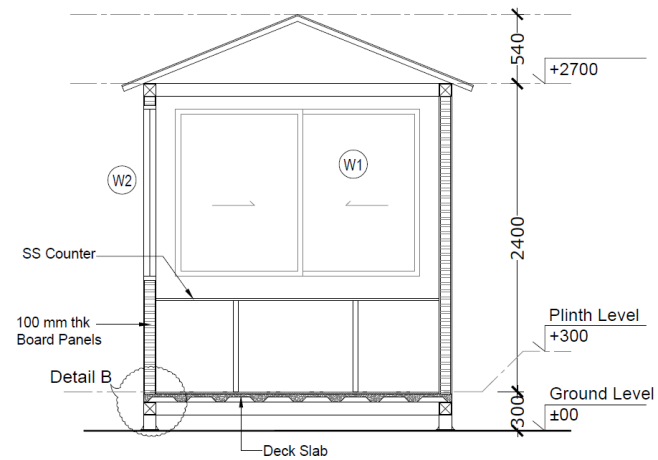
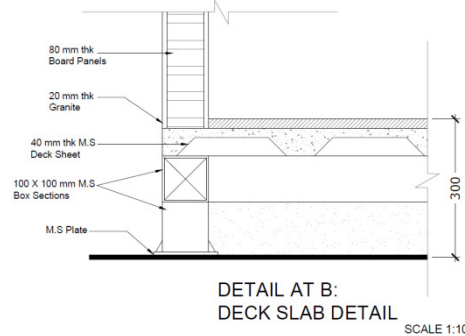
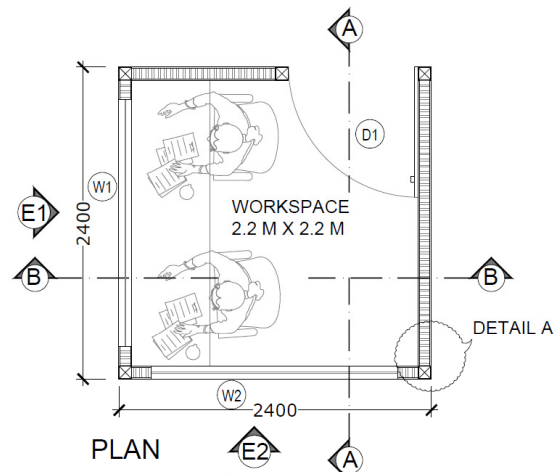

# Mohalla Clinics

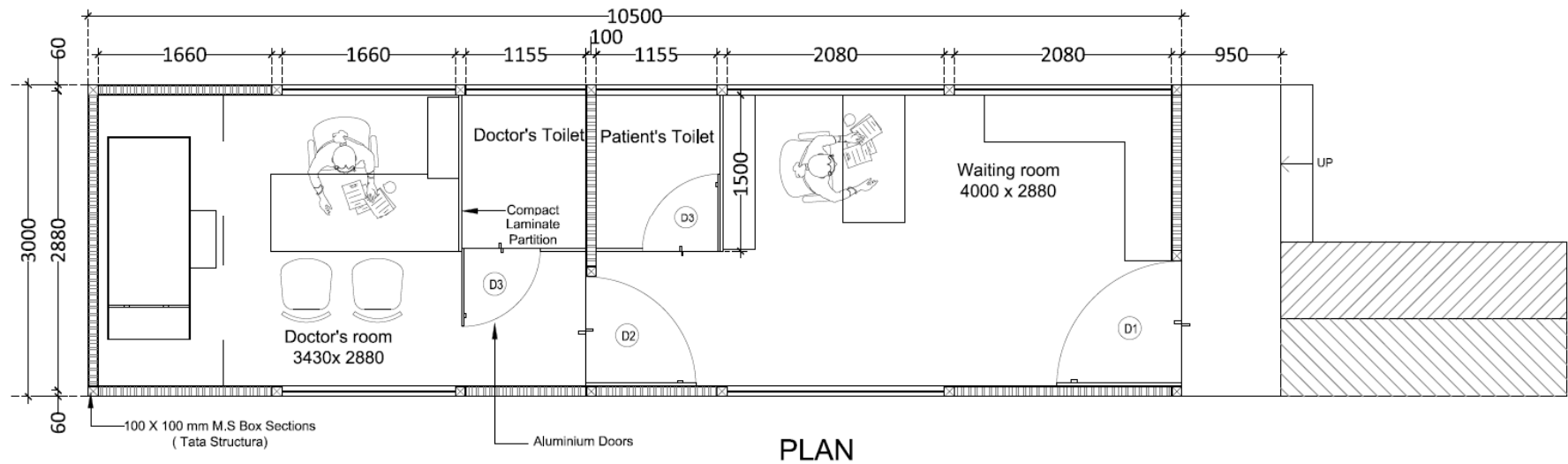



# Aam Admi Canteen

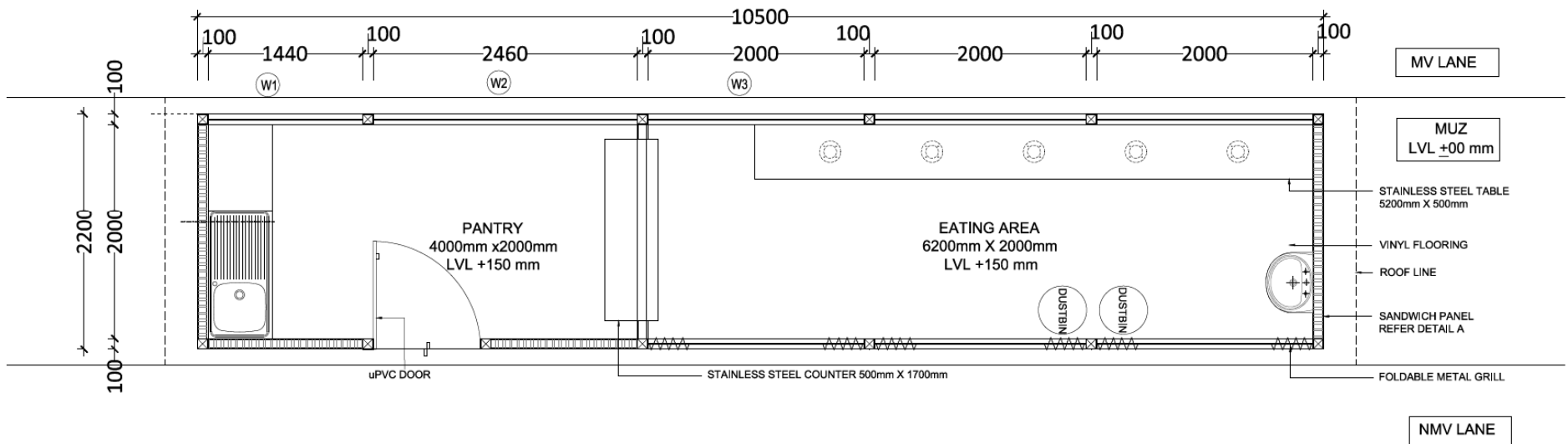

PLAN

# Community Library & Notice Boards

---



PWD, Govt. of NCT of Delhi

---