

**PROJECT MANAGER  
FLYOVER PROJECT CIRCLE F-13  
PUBLIC WORKS DEPARTMENT, GOVT. OF DELHI  
MUKARBA CHOWK, G. T. KARNAL ROAD,  
DELHI - 110033**

**Ph: 011-27691871, Fax No.: 011-27691971**

**E-Mail: pmpwddelhi13@gmail.com**

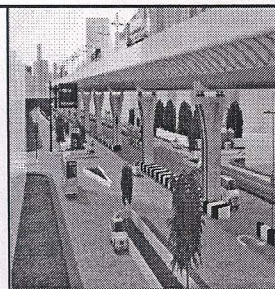

F. No. 23(29-I)/PM/FPC/F-13/PWD/2014/

2705

Date: -

10-11-14

**Inspection Note**

**Sub: - Inspection Note for the work of "Comprehensive Development of Corridor (Outer Ring Road) between Vikaspuri to Meera Bagh."**

Inspected the site of Vikaspuri to Meerabagh along with EE, F-132 and Project Manager of M/s. Simplex on 10.11.2014. Started inspection from A-2 side and reviewed the progress of RE wall of A-2 side. It was mentioned that the progress of RE wall work needs to be expedited so that an approach to the elevated corridor is made at least from one side for doing casting of crash barriers, central verge etc. The lateral pre-stressing of wings of first span was being started today. It was mentioned that in the diaphragm segment, out of 4 ducts, only 3 ducts should be stressed as on date. The 4th duct is passing through cut out of diaphragm segment and its pre-stressing should be done only after doing concreting in cut out area. The agency was also directed to ensure proper sealing of gap between spine and wing (with backing rod etc.) before doing stitching. The project Manager of M/s. Simplex was directed to start the work of casting of shear resistor etc. so that cut out portion of spine segment is casted and 4<sup>th</sup> lateral duct is pre-stressed.

Then, took the round of site and it was observed that a lot of malba was still lying on footpath and green belt where drain work has been recently taken up or completed. The Project Manager of M/s. Simplex was directed to immediately get it cleaned otherwise EE was directed to get it cleaned at the risk & cost of the agency. The shuttering of the drain at number of places needs to be replaced immediately and EE was directed not to allow the casting of drain with this bad shuttering at all. It was also directed to start the activities of c/o footpath immediately.

In the casting yard, reviewed the drawing of seismic resistor and elastomeric pad around it. The various related issues were also discussed with Mr. Ganeshan of M/s. LTR for issuing necessary clarification at the earliest. EE, F-132 may get the clarification from M/s. LTR on priority.

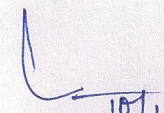
  
O/c Project Manager  
Flyover Project Circle F-13, PWD

**Copy to:-**

- (1) Chief Engineer, Flyover Project Zone F-1, PWD, 12<sup>th</sup> Floor, MSO Building, I.P. Estate, New Delhi for kind information please.
- (2) The Executive Engineers, FPD, F-132 for information & necessary action please.

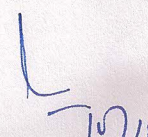
  
O/c Project Manager