

**PROJECT MANAGER**  
**FLYOVER PROJECT CIRCLE F-13**  
**PUBLIC WORKS DEPARTMENT, GOVT. OF DELHI**  
**MUKARBA CHOWK, G. T. KARNAL ROAD,**  
**DELHI - 110033**

**Ph: 011-27691871, Fax No.: 011-27691971**  
**E-Mail: pmpwddelhif13@gmail.com**

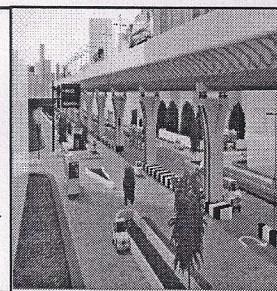

F. No. 23(24-I)/PM/FPC/F-13/PWD/2014/ 2682

Date: - 7-11-14

**Inspection Note**

**Sub: - Inspection Note for the work of "Comprehensive Development of Corridor (Outer Ring Road) between Mangolpuri to Madhuban Chowk".**

Inspected the site of Mangolpuri to Madhuban Chowk along with EE, F-134 and Project Manager of M/s. ITD on 05.11.2014 and discussed the various issues like casting & erection of spine & wing segments, casting of shear registers, crash barriers etc. in detail. The Project Manager of M/s. ITD was directed to expedite all these activities immediately. It was also pointed out that wing erection is the most critical activity and it is felt that number of cantilever wing erection trolleys should be increased immediately so that erection of wings are completed along with erection of spine segments.

Then, went to the site of A-2 pier near Deepali Chowk and discussed the levels of road on L.H.S. It was pointed out that FRL given by the consultant should be correlated with the existing road levels to avoid unwanted filling over existing road surface to the maximum possible. It was informed that on R.H.S., one waterline is coming below the main carriage way in RE wall portion above which the depth of the cover will be around 300 mm to 700 mm. At number of locations, air valves of DJB pipeline also need to be lowered or shifted. EE was directed to take up the matter with concerned DJB authorities for immediate necessary action.

Other activities like c/o footpath, drain etc. also need to be expedited.

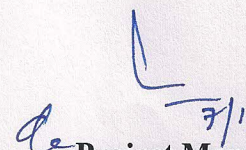
  
**Project Manager**  
**Flyover Project Circle F-13, PWD**

**Copy to:-**

- (1) Chief Engineer, Flyover Project Zone F-1, PWD, 12<sup>th</sup> Floor, MSO Building, I.P. Estate, New Delhi for kind information please.
- (2) The Executive Engineer, FPD, F-134 for information & necessary action please.

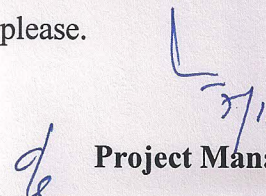
  
**Project Manager**