

PROJECT MANAGER
FLYOVER PROJECT CIRCLE F-13
PUBLIC WORKS DEPARTMENT, GOVT. OF DELHI
MUKARBA CHOWK, G. T. KARNAL ROAD,
DELHI - 110033

Ph: 011-27691871, Fax No.: 011-27691971
E-Mail: pmpwddelhi13@gmail.com

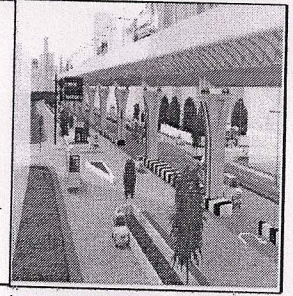

F. No. 23(29-I)/PM/FPC/F-13/PWD/2014/ 1023

Date: - 7-5-14

Inspection Note

Sub: - Inspection Note for the work of "Comprehensive Development of Corridor (Outer Ring Road) between Vikaspuri to Meera Bagh."

Inspected the site of Vikaspuri to Meerabagh along with EE, F-132 and Project Manager of M/s. Simplex today i.e. on 07.05.2014 and started inspection from Janakpuri side. EE, F-132 informed that shifting of 66 KVA line by BSES is almost stopped due to some contractual problem of BSES. The matter was discussed with Mr. Ajay Kumar, Vice-President, BSES who promised to get-back after knowing all the facts from his people. Auto Launching of Launching Girder at P-27_P28 was in progress.

At the casting yard, reviewed the drawings of Service Road Bridge & portal frames over Najafgarh Drain in the stretch from Vikaspuri to Meerabagh. Some of the issues were not clear and EE, F-132 and Mr. Soni, AEE, F-132 were directed to study the drawings in detail and discuss with the undersigned within 2-3 days. The main issue is to ensure that various structural elements like shear resistor, pedestal etc. are not conflicting with the column of portal frames.

The issue of preparing a presentation in the form of a movie was again discussed and the details to be incorporated in the presentation were explained in details.

Then went to the casting yard to see the casted segments. It has been observed that at number of places, minor damage to the concrete surface is occurring due to following reasons: -

- (1) Improper cleaning of bulkhead surface.
- (2) Gap between sheathing duct locator and bulkhead surface.
- (3) Gap between shear key form work and bulkhead surface.

This point has been raised by undersigned on number of occasions earlier and the same has also been included in the checklist so that these minor but important issues are not neglected before casting of spine segments. However, it is regretted to point out that still proper care is not being taken in this regard. EE was directed to prepare a Standard Operating Procedure (SOP) which should include the quality control aspect to be checked by Engineers of M/s. Simplex and PWD. No casting of segments should be allowed until & unless these issues are resolved and taken care off and spine segment may be rejected outrightly, if these type of issues are still observed, in future.

Regarding, drain cleaning and operationalizing new drain, it was directed that needful action should be completed by 15th May so as to ensure that no water logging occurs there during rains.

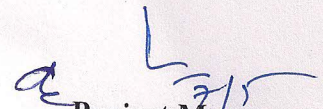
Project Manager

Flyover Project Circle F-13, PWD

Copy to:-

- (1) Chief Engineer, Flyover Project Zone F-1, PWD, 12th Floor, MSO Building, I.P. Estate, New Delhi for kind information please.
- (2) The Executive Engineers, FPD, F-132 for information & necessary action please.

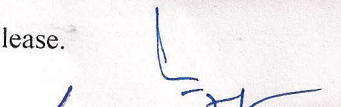
Project Manager